

## PRODUCT CARD

### **Ecowec™ hybrid heat exchanger**

The Ecowec™ R10-S(0-3) hybrid heat exchanger is a building-specific solution for recovery of heat from wastewater. The Ecowec™ hybrid heat exchanger can also be used to recover energy from other heat sources in a building (incl. exhaust air, refrigeration systems, and solar heating and electricity) and combinations thereof. The Ecowec™ unit is suitable for both new buildings and renovation projects and works with all heating systems.



#### **PROPERTIES:**

- SUITABILITY FOR USE EVEN WITH ONE-PIPE DRAINAGE SYSTEMS
- NO STORAGE OF WASTEWATER AT ANY POINT
- A SMALL FOOTPRINT: ONLY 1 m<sup>2</sup> OF FLOOR SPACE NEEDED
- SUITABILITY FOR BOTH NEW BUILDINGS AND RENOVATION
- QUICK AND EASY INSTALLATION
- E-VALUE IMPACT EVEN 14 kWh/m<sup>2</sup> ON THE BUILDING
- SUITABILITY FOR ALL HEATING SYSTEMS
- NO RISK OF BLOCKAGES
- NO NEED FOR ELECTRICITY
- ALMOST MAINTENANCE-FREE OPERATION
- GENERAL WASTEWATER HEAT RECOVERY EFFICIENCY OF 30–70%
- MANUFACTURE IN FINLAND
- UTILITY MODEL PROTECTION IN FINLAND AND GERMANY
- PATENT APPLICATION SUBMITTED (FI/PCT)

Ecowec™ R10-S(0-3) hybrid heat exchanger. The model in the picture includes accessories.  
Wasenco Oy reserves all rights.

## Dimensions and technical data

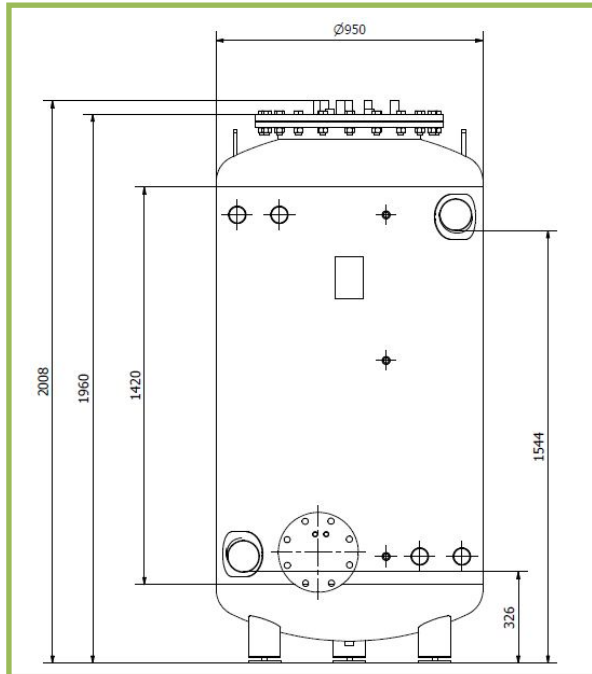

Main dimensions from the side

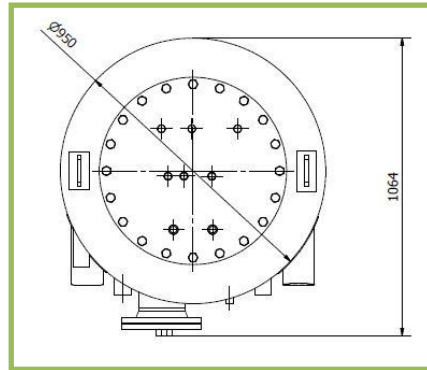

Main dimensions from the top

### **Pipe coupling dimensions:**

- Wastewater exchange pipe, outer diameter DO 114.3 mm 304/316 (ASTM), PN10, connected to the sewage pipe via a V-band or a flange connection
- On the cover: 2 x DN20 / 3/4 in FS, for inlet, safety valve DN20 / 4 bar, and bleed valve
- On the front: 4 x DN50 / 2 in FS, connections to a heat pump's primary circuit or resistors
- On the front: 3 x 1/2 in FS, for temperature measurement
- On the bottom: 1 x 3/4 in FS, for outlet

### **Other specifications:**

- Lifting rings: 2 pcs
- Adjustable legs on the bottom: 3 pcs
- Weight: 425 kg when fully equipped
- Volume: 996–1036 litres

### **Accessories:**

- Swappable heat exchangers, 3 pcs 304/316 (ASTM), PN10
- Manifolds, 2 pcs (inlet/outlet) connected to swappable heat exchangers with DN50 / 2 in FS
- Rinse coupling, DN15 / 1/2 in FS, for the wastewater exchanger pipe washing
- Condensation insulation 20 mm PE/Velour, factory-manufactured, installation with Velcro closure at site
- Solar exchanger coil with DN150 flange connection, 18 mm ribbed copper
- Flanges for wastewater pipe connections, 304/316 (ASTM) 114.3 mm / DN100
- Electrolytic polish (finishing)

### **Pressure classes:**

- Tank: 304/316 (ASTM), PN4
- Pipes: 304/316 (ASTM), PN10
- Pressure vessel class II